

Queen's Highway, Eleuthera

Single Family Vacant

REF#00019

**COLDWELL
BANKER**

**LIGHTBOURN
REALTY**

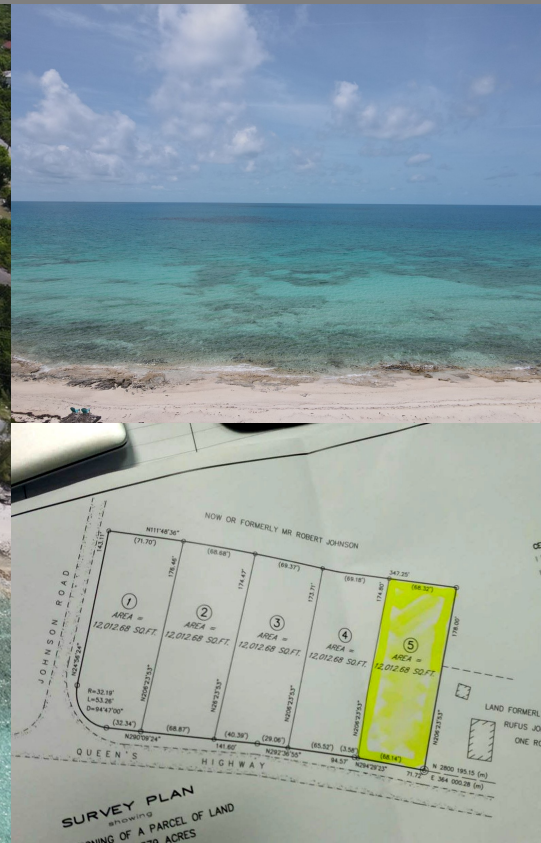

LOT SIZE

12,000 sq.
ft.

\$95,000

Location: Queen's Highway, Eleuthera

Amenities: Beach Access, Beach Front, Ocean Front, Ocean View.

Summary: Lot 4, James Cistern is a quarter acre (12,000+ square feet) elevated beachfront lot with 65 feet of frontage on the main Queen's Highway in James Cistern, Eleuthera, the Jewel of The Bahamas. The lot is open zoned, offering endless potential for a home, business or mixed use.

This property offers amazing views of the Caribbean sea of Eleuthera, a rare find in this market, being the preferred side of the island due to the calm and stunning Azure hues along with amazing coveted Bahamian sunsets. Build your vacation home or cottages and enjoy Airbnb rental income, so many options with this amazing location.

The lot is low maintenance with native indigenous trees and palms making your landscaping already made by mother nature. Eleuthera is truly a nature lovers paradise and James Cistern is the epitome of the real old school Bahamian town, with very friendly people, several local restaurants offering delicious native and international cuisine along with several grocery stores all within walking distance.

Shannon Knowles

Eleuthera, Bahamas
Cell: 242 427.0977
Email: shannon@cbbahamas.com
cbbahamas.com

